

Specification

| | | |
|----------------------------------|---|----------------------------------|
| Nominal Voltage | 2V | |
| Nominal Capacity(10HR) | 2500.0AH (1.8V/cell,20 °C) | |
| Dimension | Length | 487 ± 3mm (19.2 inches) |
| | Width | 212 ± 3mm (8.35 inches) |
| | Container Height | 772 ± 3mm (30.4 inches) |
| | Total Height (with Terminal) | 827 ± 3mm (32.56 inches) |
| Approx Weight | Without Electrolyte | 138 kg (304.24lbs) |
| | With Electrolyte | 193 kg (425.49lbs) |
| Container Material | SAN transparent container | |
| Rated Capacity | 2500.0 AH/250.0A | (10hr,1.80V/cell,20 °C/68 °F) |
| | 2220.5 AH/444.1A | (5hr,1.75V/cell,20 °C/68 °F) |
| | 1927.5 AH/642.5A | (3hr,1.75V/cell,20 °C/68 °F) |
| | 1427.5 AH/1427.5A | (1hr,1.60V/cell,20 °C/68 °F) |
| Max. Discharge Current | 20000A (5s) | |
| Internal Resistance | Approx 0.13mΩ | |
| Operating Temp.Range | Discharge | -15 ~ 50 °C (5 ~ 122 °F) |
| | Charge | 0 ~ 40 °C (32 ~ 104 °F) |
| | Storage | -15 ~ 40 °C (5 ~ 104 °F) |
| Type and number of poles | M8 | |
| Charging | Floating voltage: | 2.23V~2.25V at 20 °C(68 °F)Temp. |
| | Boost charge: | 2.30V~2.40V at 20 °C(68 °F)Temp. |
| | Charging current(max.): | 0.1CA |
| | Temp.Coefficient | -3mV/ °C |
| Capacity affected by Temperature | 40 °C (104 °F) | 103% |
| | 25 °C (77 °F) | 100% |
| | 0 °C (32 °F) | 86% |
| Self Discharge | CBB OPzS batteries may be stored for up to 6 months at 20 °C(68°F) and then a freshening charge is required. For higher temperatures the time interval will be shorter. | |



Applications

- ◆ Telecommunications.
- ◆ Radio and cellular telephone relay stations.
- ◆ Emergency lighting systems.
- ◆ Power stations, Conventional power stations,
- ◆ alternative power (solar; wind).
- ◆ Large UPS and computer back-up.
- ◆ Railway signalling.
- ◆ Maritime standby power on ships and ashore.
- ◆ Standby power.
- ◆ Buoy lighting.
- ◆ Long service life, designed life 15-20 years.

Constant Current Discharge (Amperes) at 20°C (68°F)

| F.V/Time | 30min | 45min | 1h | 1.5h | 2h | 3h | 4h | 5h | 6h | 8h | 10h | 20h |
|-------------|--------|--------|--------|--------|-------|-------|-------|-------|-------|-------|-------|-------|
| 1.60 V/cell | 1895.0 | 1646.7 | 1427.5 | 1125.0 | 930.0 | 695.0 | 558.8 | 472.5 | 409.0 | 323.6 | 267.4 | 145.0 |
| 1.65V/cell | 1780.0 | 1583.3 | 1380.0 | 1096.7 | 908.8 | 683.3 | 550.6 | 466.2 | 403.4 | 319.7 | 264.2 | 143.6 |
| 1.70V/cell | 1690.0 | 1493.3 | 1327.5 | 1061.7 | 887.5 | 663.3 | 538.1 | 456.1 | 395.8 | 314.1 | 259.9 | 141.6 |
| 1.75V/cell | 1585.0 | 1423.3 | 1260.0 | 1011.7 | 850.0 | 642.5 | 521.9 | 444.1 | 386.3 | 308.9 | 255.5 | 139.3 |
| 1.80V/cell | 1410.0 | 1283.3 | 1160.0 | 948.3 | 798.8 | 610.0 | 499.6 | 425.7 | 372.1 | 300.4 | 250.0 | 136.6 |
| 1.85V/cell | 1125.0 | 1063.3 | 992.5 | 843.3 | 725.0 | 558.3 | 462.3 | 399.0 | 350.4 | 285.6 | 239.4 | 131.4 |

Constant Power Discharge (Watts) at 20°C (68°F)

| F.V/Time | 30min | 45min | 1h | 1.5h | 2h | 3h | 4h | 5h | 6h | 8h | 10h | 20h |
|-------------|--------|--------|--------|--------|--------|--------|--------|-------|-------|-------|-------|-------|
| 1.60 V/cell | 3234.8 | 2881.7 | 2534.5 | 2022.4 | 1691.2 | 1272.9 | 1032.3 | 879.0 | 765.8 | 608.6 | 504.8 | 274.9 |
| 1.65V/cell | 3104.5 | 2803.6 | 2470.5 | 1981.4 | 1660.8 | 1257.8 | 1022.4 | 871.7 | 759.1 | 604.2 | 501.4 | 273.6 |
| 1.70V/cell | 2987.9 | 2672.0 | 2394.4 | 1930.9 | 1629.0 | 1226.9 | 1002.6 | 856.2 | 747.2 | 596.0 | 494.8 | 270.8 |
| 1.75V/cell | 2849.5 | 2573.9 | 2294.2 | 1853.2 | 1571.6 | 1195.8 | 977.3 | 837.5 | 731.6 | 588.1 | 488.8 | 267.5 |
| 1.80V/cell | 2569.3 | 2356.1 | 2139.2 | 1757.3 | 1490.0 | 1144.0 | 941.2 | 806.7 | 709.1 | 575.1 | 480.8 | 263.8 |
| 1.85V/cell | 2084.6 | 1980.6 | 1857.2 | 1584.0 | 1367.4 | 1058.3 | 879.7 | 762.6 | 673.1 | 550.9 | 463.9 | 255.8 |

Dimensions

Terminal

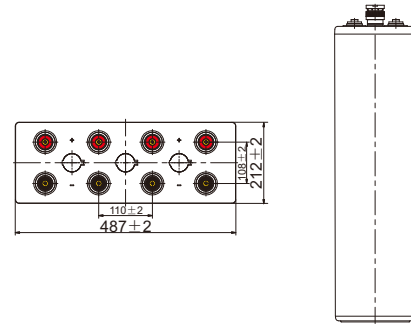
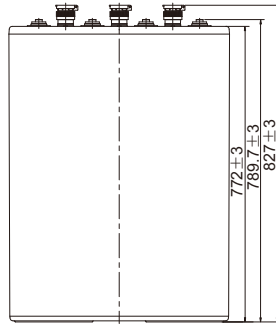
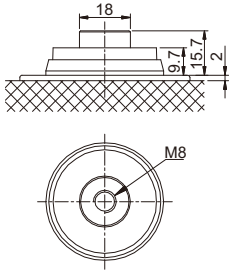

Discharge Characteristics

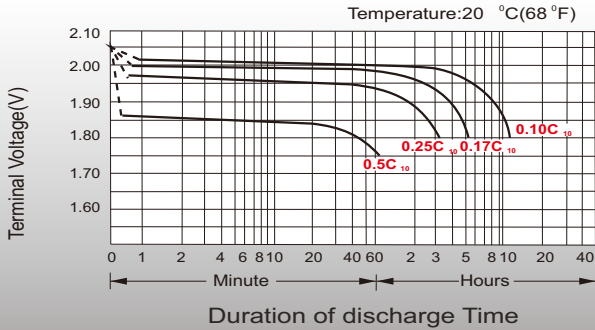

Charge voltage Vs ambient temperature curve

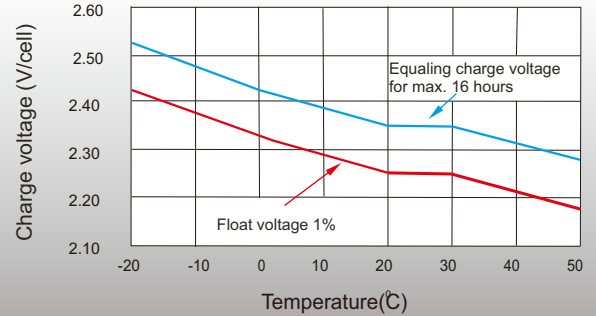

Discharge capacity Vs Ambient temperature curve (I10A)

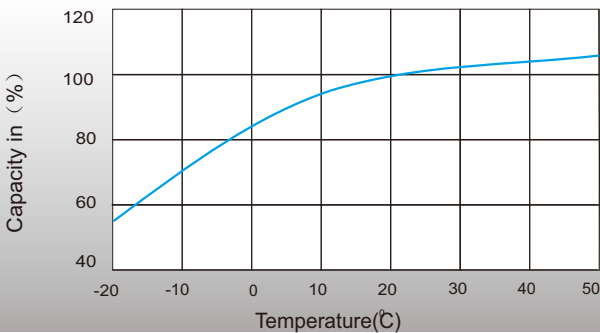

Relation curves of service life and ambient temperature

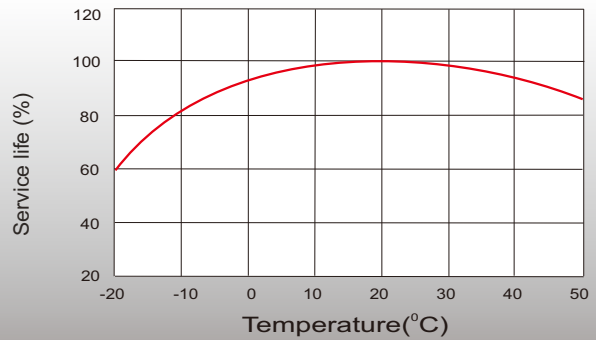

Self Discharge Characteristics

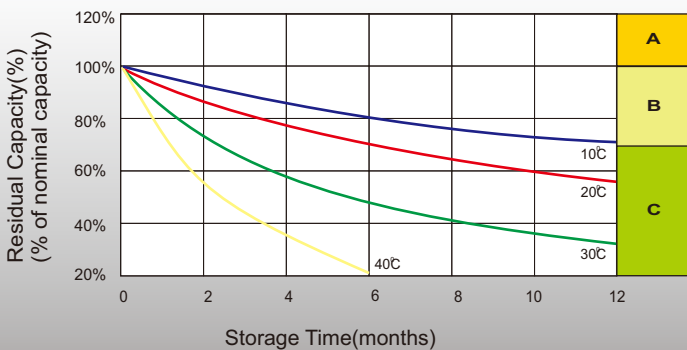

- A** No supplementary charge required (Carry out supplementary charge before use if 100% capacity is required.)
- B** Supplementary charge required before use. Optional charging way as below:
 1. Charged for above 3 days at limited current 0.1CA and constant voltage 2.25V/cell.
 2. Charged for above 20 hours at limited current 0.1CA and constant voltage 2.45V/cell.
 3. Charged for 8~10 hours at limited current 0.05CA.
- C** Supplementary charge may often fail to recover the capacity. The battery should never be left standing till this is reached.