

Material	铁板	Nanjing Meishuo Building Materials Co, Ltd	MSDK	L05JT06	14
Thickness	刘明辉				
Colour	刘云雷				
Hardness and weight					
Picture No.	13				

1. Clean the garbage and check if the gap is equally wide and straight.

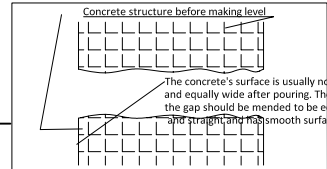

2. Make level

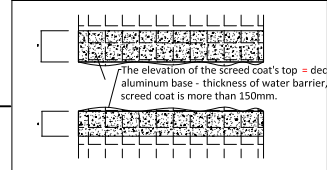

3. Make level with high strength of cement mortar. The width is more than 150mm.

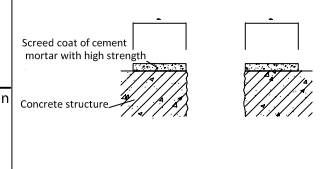

4. Install the fire barrier. Then Snap the ink line on the screed coat to confirm the sidelines of the aluminum base.

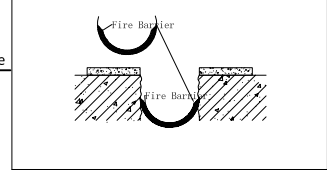

5. Install the water barrier. The side line of water barrier can't cover the ink line snapped. (Brush the special glue on the surface of the screed coat and the lower surface of the water barrier. After the glue is almost air drying, put the water barrier on the screed coat.)

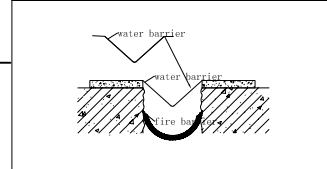

Plan view

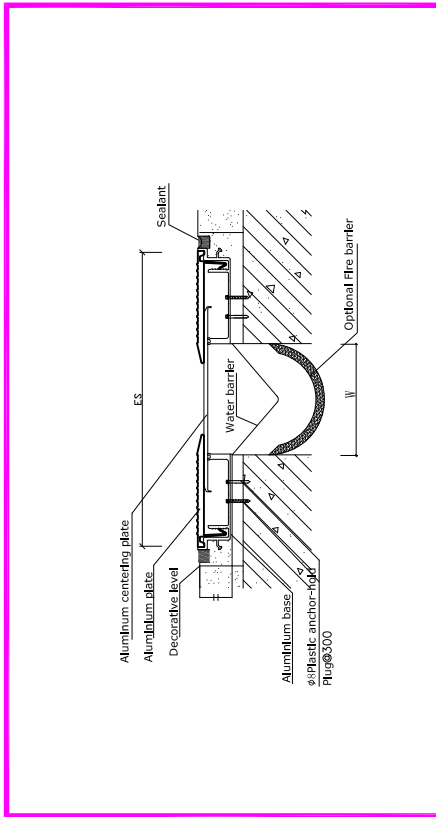

Material	铁板	Nanjing Meishuo Building Materials Co, Ltd	MSDK	L05JT06	14
Thickness	刘明辉				
Colour	刘云雷				
Hardness and weight					
Picture No.	13				

6. Install the aluminum frame and make sure they are straight .

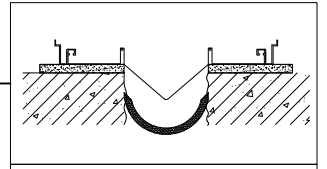

7. Nail the scree to make sure the base on a straight line.

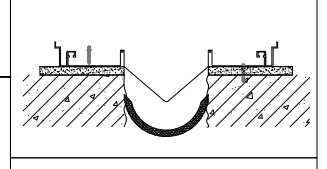

8. Make the Decorative level to make sure it has the same elevation with the aluminum base. And fill with sealant to make sure the aluminum base and decorative level to connect tightly and won't leak.

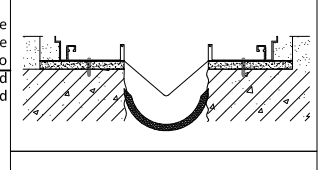

9. Fill in the Sealant.

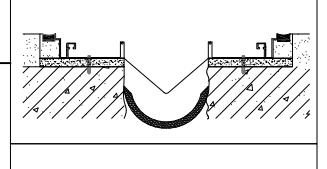

10. Lay the center plate on the aluminum base.

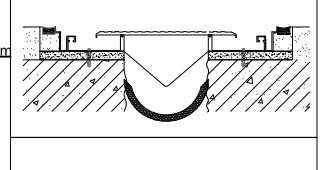

11. Put and Lock the cover plate in the aluminum frame. Installation finish.

