



eLED

eLED-EDI-7050 Edison Modular Passive Star LED Heat Sink Φ 70mm

Features VS Benefits

- * The eLED-EDI-7050 Edison Modular Passive LED Coolers are specifically designed for luminaires using the Edison LED engines.
- * Mechanical compatibility with direct mounting of the LED engines to the LED cooler and thermal performance matching the lumen packages.
- * For spotlight and downlight designs from 900 to 2500 lumen.
- * Thermal resistance range Rth 2.18°C/W.
- * Modular design with mounting holes foreseen for direct mounting of Edison EdiLex SLM EdiLex II COB LED engines.
- * Diameter 70mm - standard height 50mm Other heights on request.
- * Extruded from highly conductive aluminum.

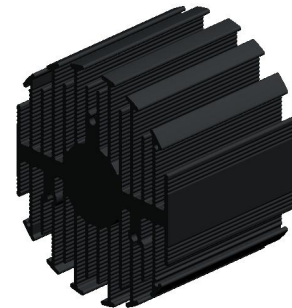

Zhaga LED engine and radiator assembly is a unified future international standardization

- * Below you find an overview of Edison engines COB's and LED modules which standard fit on the eLED coolers.
- * In this way mechanical after work and related costs can be avoided, and lighting designers can standardize their designs on a limited number of LED coolers.

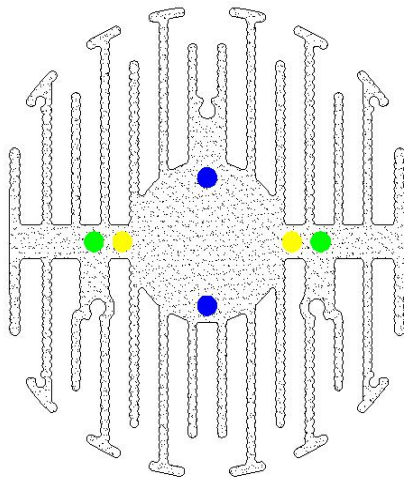

Edison LED engines Mounting Options

For the EdiLex Spot Light Module (SLM).

- 5PHR22WWS0010002;
- 5PHR22NWS0010002;

For the EdiLex II HM Series LED engines.

- (AAG.STUCCHI holder:8101-G2); (BJB holder:47.319.2021.50);
- 2PHM16WW27P13001; 2PHM16CW27P13001;
- 2PHM16NW27P13001;

For the EdiLex II HM CRI90 Series LED engines.

- (AAG.STUCCHI holder:8101-G2); (BJB holder:47.319.2021.50);
- 2PHM16WW38P13001; 2PHM16CW38P13001;
- 2PHM16NW38P13001;

For the EdiLex II MV Series LED engines.

- (AAG.STUCCHI holder:8101-G2); (BJB holder:47.319.2021.50);
- 2PMV20WW27P13001; 2PMV20CW27P13001;
- 2PMV20NW27P13001;

Zhaga Book3 Green indicator marks:

Direct mounting with machine screws M3x6mm;

Edison LED engines directly Mounting Options

For the EdiLex II Star CRI90 Series LED engines.

- 2PHV10WW38P05001; 2PHV10CW38P05001;
- 2PHV10NW38P05001;

For the EdiLex II Star Series LED engines.

- 2PHV10WW27P05001; 2PHV10CW27P05001;
- 2PHV10NW27P05001;

Direct mounting with machine screws M3x6mm;
Blue indicator marks.

For the EdiLex II SD Series LED engines.

- 2PSD24WW01P02001; 2PSD24CW06P02001;
- 2PSD24NW05P02001;

Direct mounting with machine screws M3x6mm;
Yellow indicator marks.



for

LED



eLED

eLED-EDI-7050 Edison Modular Passive Star LED Heat Sink Φ 70mm

Mounting Options and Drawings & Dimensions

Example:eLED-EDI-7050-B-3

Example:eLED-EDI-7050-1-2-3

1 Height (mm)

2 Anodising Color

B-Black

C-Clear

Z-Custom

3 Mounting Options - see graphics for details Combinations available

Ex.order code - 12

means option 1 and 2 combined

Notes:

- Mentioned models are an extraction of full product range.

- For specific mechanical adaptations please contact MingfaTech.

MingfaTech reserves the right to change products or specifications without prior notice.



MOUNTING OPTION	Module type	Holder NO.	THREAD	THREAD DEPTH	THREAD HOLE DISTANCE
1	EdiLex II Star	/	M3	6.5mm	19.0mm/ 2-@180°
2	EdiLex II SD	/	M3	6.5mm	26.2mm/ 2-@180°
3	EdiLex II HM	AAG.STUCCHI: 8101-G2	M3	6.5mm	35.0mm/ 2-@180°
	EdiLex II MV	BJB: 47.319.2021.50			
	EdiLex II SLM	/			

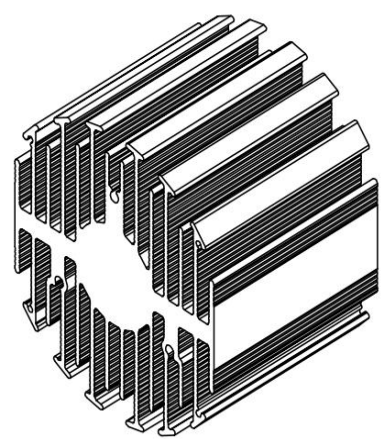
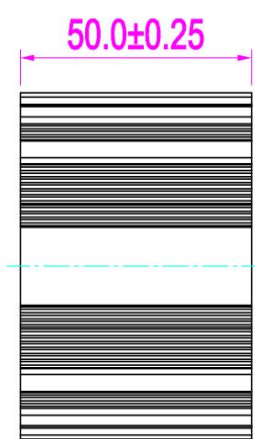
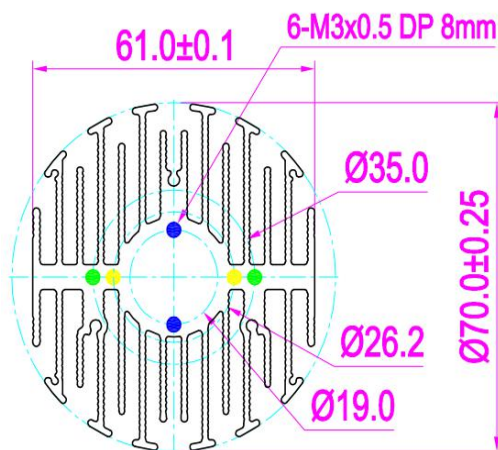

Tel:+86-769-39023131
 E-fax:+86-(020)28819702 ext:22122
 Email:sales@mingfatech.com
 Http://www.heatsinkled.com
 Http://www.mingfatech.com



eLED

eLED-EDI-7050 Edison Modular Passive Star LED Heat Sink $\Phi 70$ mm

The thermal data table

	 <i>eLED-7050</i>
Model No.	eLED-EDI-7050
Size	$\Phi 70 \times H 50$mm
Material	AL6063-T5
Finish	Black Anodized
Weight(gr)	206
Thermal Wattage	22.9W
Heatsink Θ_{s-a^2}	73369
Heat Sink T Rise Above Ambient	2.18

Dissipated Power Pd(W)	Heat sink to ambient thermal resistance Rhs-amb ($^{\circ}\text{C}/\text{W}$)	
	eLED-EDI-7050	
5	3.40	17
10	2.80	28
15	2.70	37
20	2.25	45
25	2.16	54

